

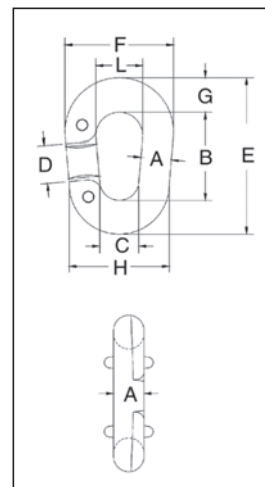

G-334 / S-334
Replacement Link

- Forged Steel - Quenched and Tempered.
- Has larger inside dimensions making it easier to attach hooks or other fittings to the chain.
- An exclusive Crosby product.
- After making connections, rivets must be peened.



G-334/S-334 Pear Shape “Missing Link”® Replacement Links

Chain Size (mm)	Stock No.		Working Load Limit (t)*	Weight Per 100 (kg)	Dimensions (mm)								
	G-334 Galv.	S-334 S.C.			A	B	C	D	E	F	G	H	L
10	1013432	1013441	.84	11.3	10.4	51.0	14.2	20.6	74.5	41.4	11.9	35.1	20.6
13	1013450	1013469	1.50	22.7	12.7	63.5	17.5	25.4	92.0	51.0	14.2	42.9	25.4
16	1013478	1013487	2.27	34.0	16.0	70.0	20.6	26.9	102	60.5	16.0	52.5	28.7
19	1013496	1013502	3.22	56.7	19.1	79.5	25.4	28.7	121	70.0	20.6	63.5	31.8
22	1013511	1013520	4.35	90.7	22.4	93.5	31.8	35.1	141	82.5	23.9	76.0	38.1

* Ultimate Load is 4 times the Working Load Limit.

Not Suitable for use with Grade 80 or Grade 100 chain and chain slings used in overhead lifting.

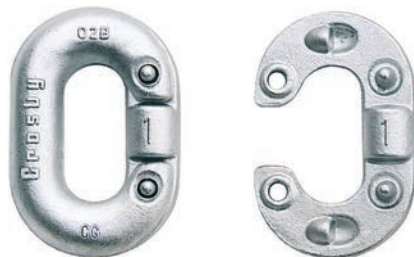

G-335 / S-335
Replacement Link

- Forged Steel - Quenched and Tempered.
- Integral rivets join the two halves.
- After making connections, rivets must be peened.

Meets or exceeds the performance requirements of Federal Specifications RRC-271D, Type II, except for those provisions required of the contractor. For additional information, see page 476.

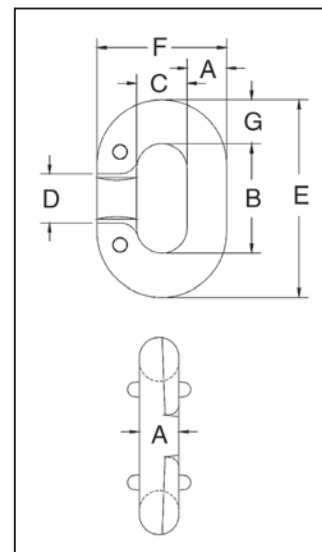

G-335/S-335 “Missing Link”® Replacement Links

Chain Size (mm)	Stock No.		Working Load Limit (t)*	Links Per Box	Weight Per 100 (kg)	Dimensions (mm)						
	G-335 Galv.	S-335 S.C.				A	B	C	D	E	F	G
** 5	1013094	1013101	.36	20	1.13	6.35	17.5	8.65	8.65	30.2	19.8	7.10
** 7	1013110	1013129	.60	10	2.83	7.10	22.4	11.2	11.2	38.1	25.4	7.85
** 8	1013138	1013147	.89	10	5.67	8.65	23.9	11.9	11.9	42.9	29.5	9.65
10	1013156	1013165	1.25	10	9.07	10.4	28.7	14.2	14.2	52.5	35.1	11.9
11	1013174	1013183	1.65	10	12.5	11.9	32.5	15.0	15.0	59.5	38.9	13.5
13	1013192	1013209	2.15	10	17.0	13.5	37.3	16.8	16.8	67.5	43.7	15.0
16	1013236	1013245	3.30	10	32.9	16.8	46.0	19.8	20.6	84.0	53.0	19.1
19	1013254	1013263	4.65	10	55.5	19.8	54.0	23.9	26.9	98.5	63.5	22.4
22	1013272	1013281	5.45	Bulk	79.5	23.1	63.5	28.7	28.7	114	74.5	25.4
† 26	1013290	1013307	7.00	Bulk	113	26.2	70.0	31.8	31.8	127	84.0	28.7

* Ultimate Load is 4 times the Working Load Limit. ** Rivets Only - No interlocking lugs. † Has reinforced rivet holes. All sizes have countersunk rivet holes.

Not Suitable for use with Grade 80 or Grade 100 chain and chain slings used in overhead lifting.